

Stair Detail

not to scale

3

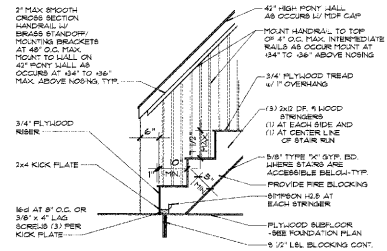

Stair Detail

not to scale

2

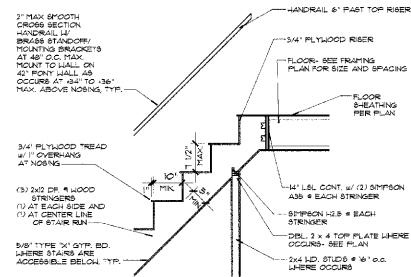

Stair Detail

not to scale

1

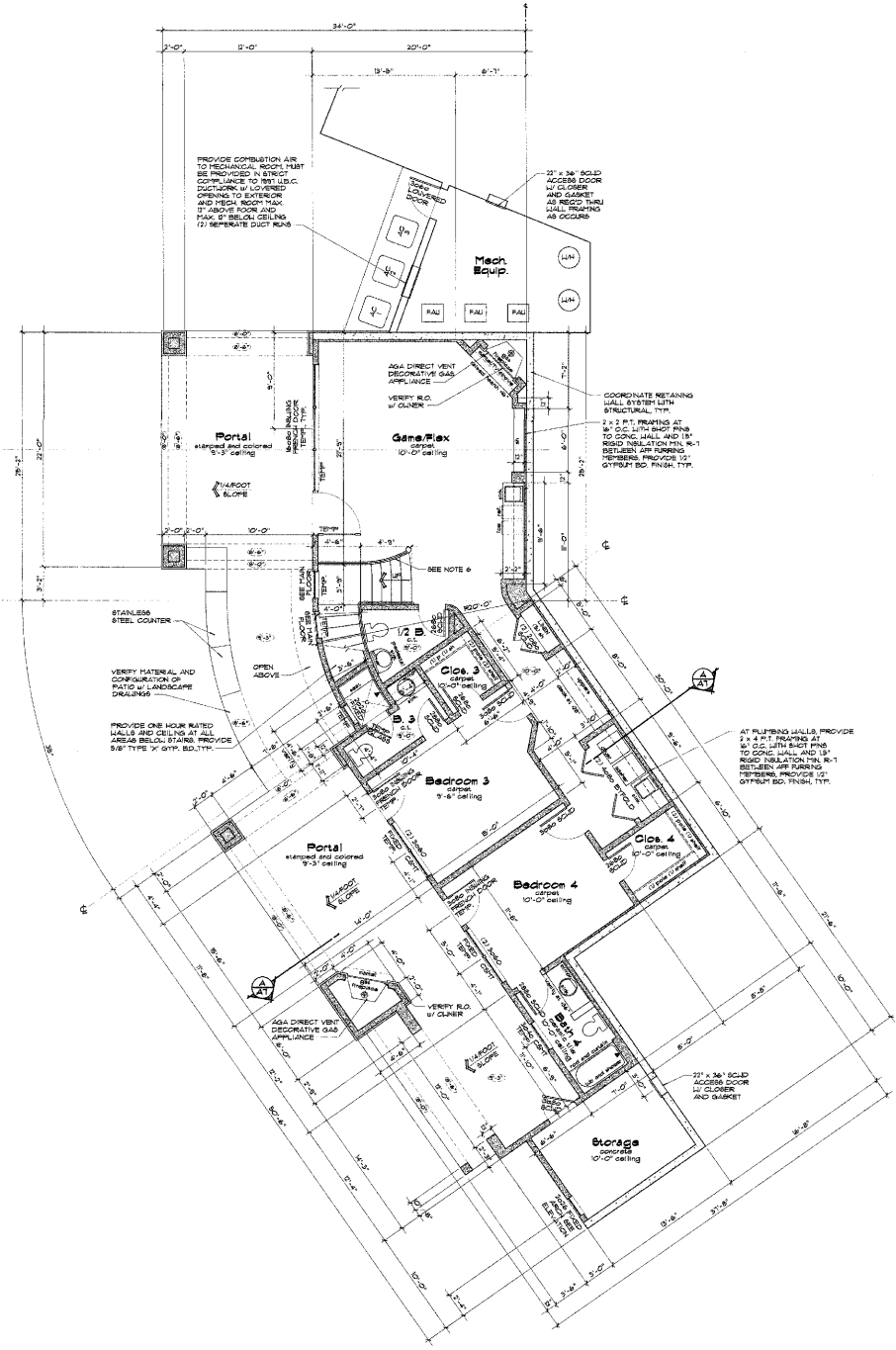

Lower Floor Plan

3/16"=1'-0"

1271 s.f. living  
992 s.f. portal  
119 s.f. storage



- Floor Plan Notes:**
1. ALL WINDOW ARE REFERENCED FROM THE FINISHED FINISH LINE. PROVIDE INSULATED GLASS VINYL FRAME WINDOW, TYP.
  2. TYPICAL EXTERIOR WALLS SHALL BE 2" x 4" D.P. OR BETTER WOOD STUDS AT 16" O.C. UNLESS NOTED OTHERWISE.
  3. TYPICAL INTERIOR WALLS SHALL BE 2" x 4" D.P. OR BETTER WOOD STUDS AT 16" O.C. UNLESS NOTED OTHERWISE.
  4. PROVIDE R-13 INSULATION AT ALL WALLS SURROUNDING BATHROOMS, UTILITY CLOSET, ADJACENT ROOMS AND SPACE.
  5. PROVIDE SOLID BRACKETS AT ALL LOCATIONS OF WALL MOUNTED EQUIPMENT AND FURNISHINGS TYP. (IE. TOILET PAPER HOLDERS, TOWEL BARS, UPPER CABINETS, ETC.) COORDINATE MOUNTING LOCATION w/ GLAZER AS REQUIRED.
  6. WINDOW/ IRON HANDRAIL/QUADRANT AT 18" ABOVE FINISH DEEP w/ SPACING BETWEEN ALL MEMBERS TO BE 4" O.C. MAX. REEL 1/2" x 3/4" x 3/8"

**New Residence for:  
Behl Home Construction**  
 5915 Flowering Sage Court, Lot 1935 ArrowCreek  
 Reno, Nevada

Miles  
Architectural  
Group



501 Hermit Lane  
Reno, Nevada  
89511

phone 775.862.8802  
fax 775.862.8803  
MilesMAG@aol.com

date Sept. 17, 2004  
job no. 540

**A.3**